

When used in copy mode, the cursor of 101A is misaligned.

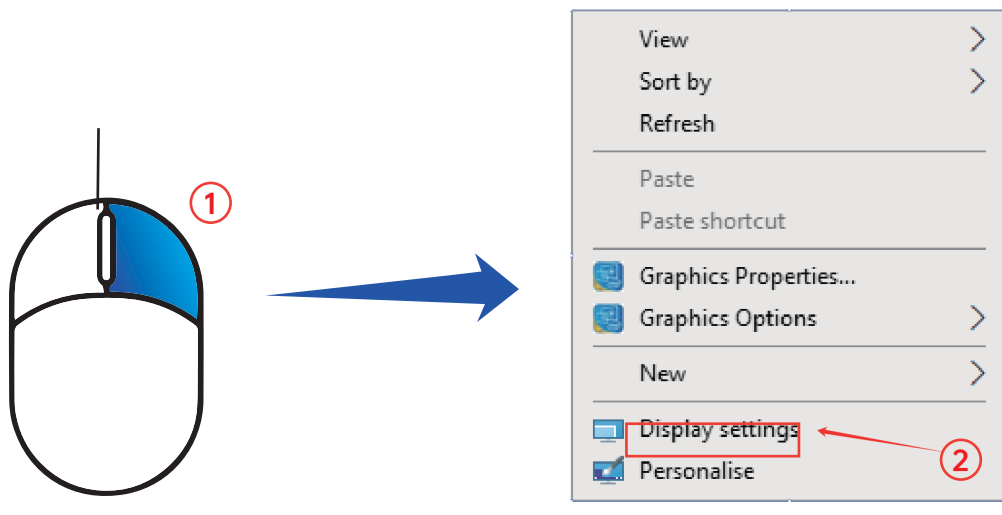

Step 1: Set the handwriting screen to expansion mode

① Right-click on the computer desktop with the mouse to bring up.



② Click on "display", scroll down to find "Multiple display", and change "Duplicate these displays" to "Extend these displays".

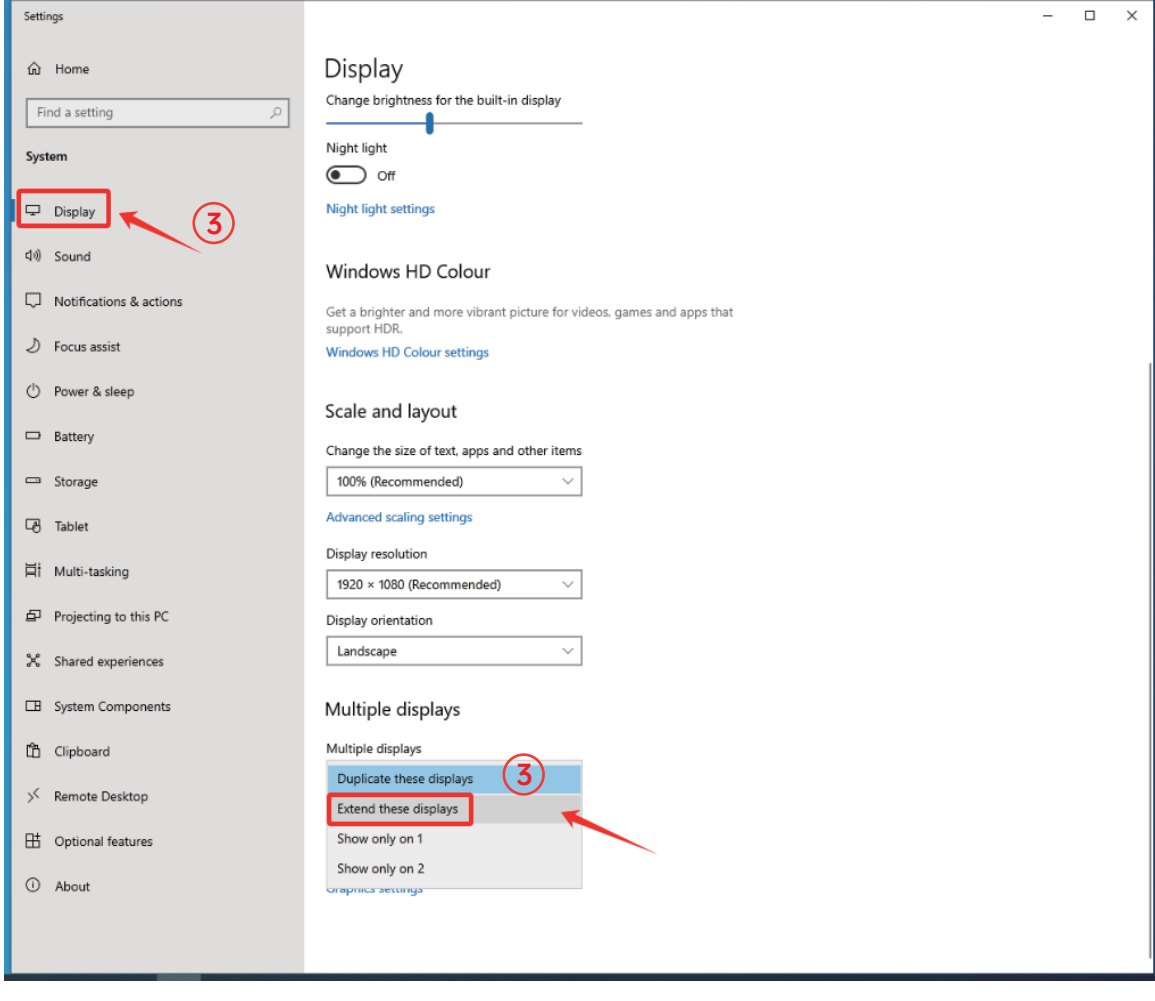

Step 2: Set the pen driver

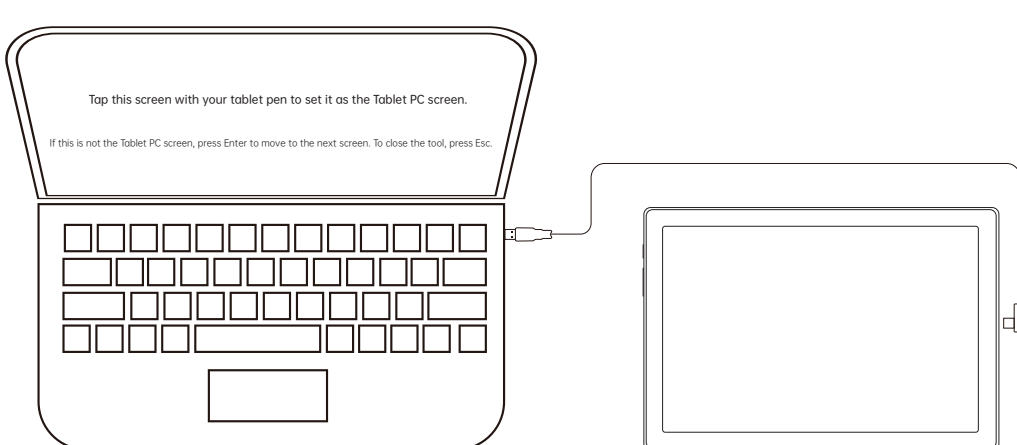
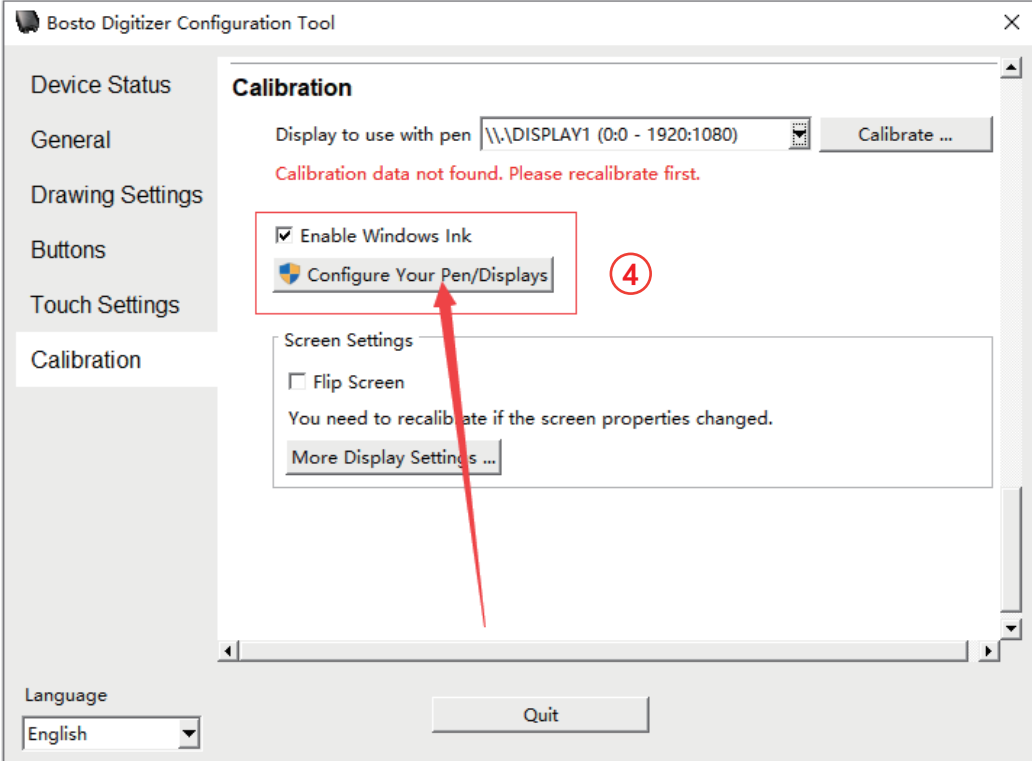
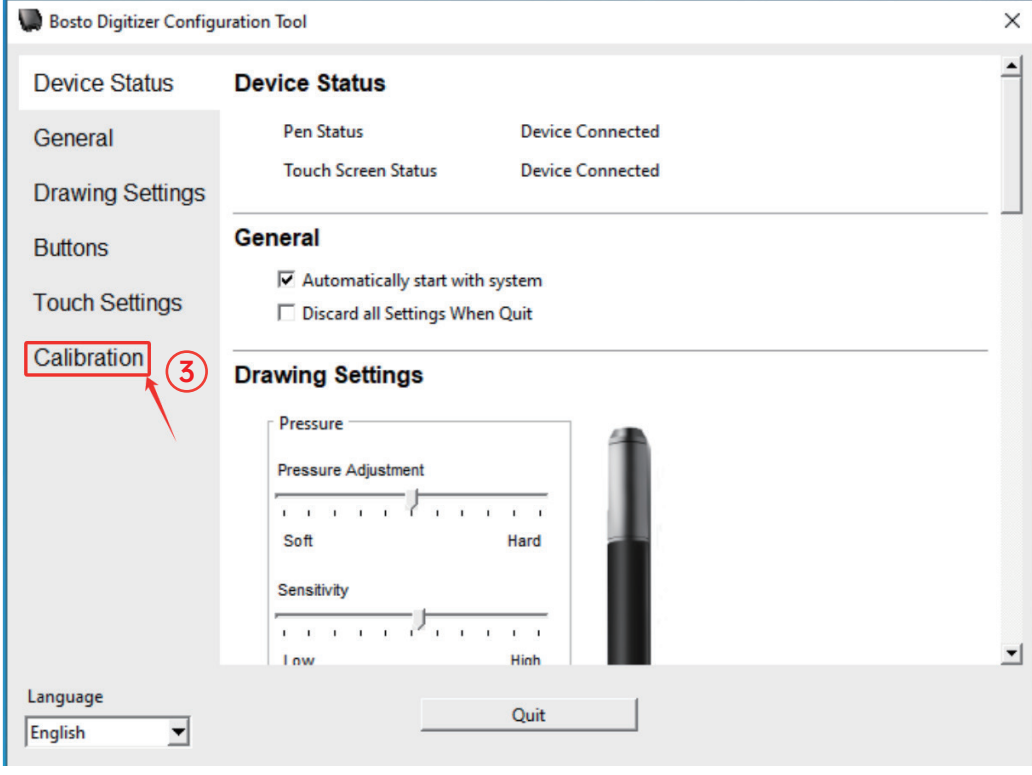
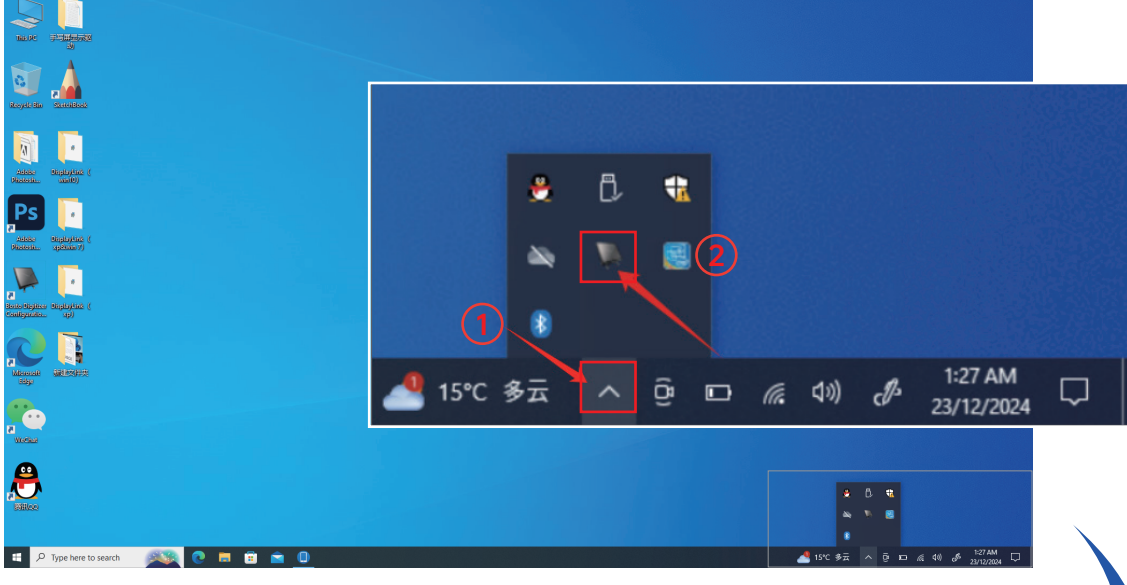

Press the Enter key:



Once the above settings are completed, the problem of cursor misalignment can be solved.